

**QAI Listing B1072-1B Construction Solutions Dryer Vent Box
 CAN/ULC S115, ASTM E814
 30 Minute Fire Wall Membrane Penetration Assembly
 Non-Load Bearing**

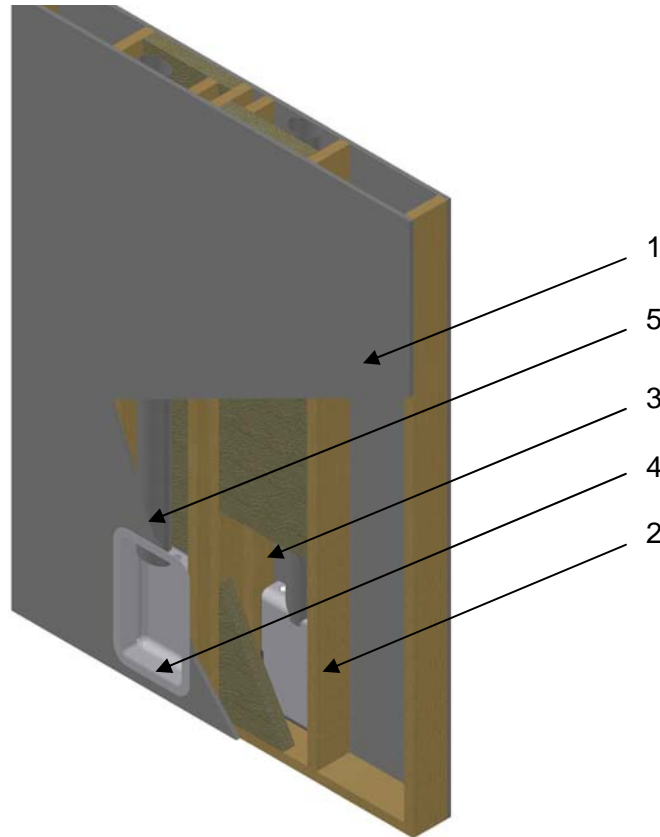

No.	COMPONENT	DESCRIPTION	
1	Gypsum Board	Type:	Type X gypsum wallboard complying with ASTM C1396 and labeled by an approved agency
		Thickness:	Single layer of 5/8 in. (16 mm) on each face of the wall
		Application:	Sheathing is to be fastened to studs with #6 x 1-5/8 in. (41 mm) long coarse thread drywall screws spaced at 8 in. on center. Joints to be taped and mudded, and fastener heads to be mudded.
2	Wall Studs	Stud Type:	Minimum nominal 2 x 6 in. (50 x 152 mm) Wood
		Stud Spaced	Maximum 16 in. (406 mm) on center
3	Cavity Insulation	Type:	Mineral wool thermal insulation in compliance with ASTM C553 Type VII
		Minimum Thickness:	2 inch (50 mm)
		Nominal Density:	Nominal Density:
	Insulation Behind the Dryer Vent Box	Type:	Mineral wool thermal insulation in compliance with ASTM C612 Type IVA
		Dimensions:	10 in. (254 mm) x 17 in. (432 mm) x 1 in. (25 mm) thick directly behind the box
		Nominal Density:	3.5 lb/ft ³ (56 kg/m ³)
Install:	A 10 in. by 17 in. area shall be cut from the 2 in. cavity insulation in the area behind the Dryer Vent Box, a 10 in. by 17 in. piece of 1 in. insulation shall then be placed in the cut out.		

No.	COMPONENT	DESCRIPTION	
4	Dryer Vent Box	Certified Product:	Nominal 6 in. Construction Solutions Dryer Vent Box Kit
		Box Dimensions:	10 in. (254 mm) wide by 17 in. (432 mm) high by 5 in. (127 mm) deep with a 1-1/4 in. (32 mm) flange. A 4-3/16 in. (106 mm) circular cut out for the dryer vent on the top and 1-1/8 in. (29 mm) knockouts on the top and bottom for gas hook up. The box is formed from 22 gauge galvanized steel.
		Trim Ring Dimensions:	9-7/8 in. (251 mm) wide by 16-7/8 in. (429 mm) high by 1-5/8 in. (41 mm) deep with a 1-5/16 in. (33 mm) flange. The trim ring is made from 25 gauge galvanized steel.
		Caulking:	PFP 4800DW
		Installation:	A nominal 2 x 4 in. (50 x 100 mm) stud is installed into the stud cavity 10-3/4 in. (273 mm) from a 2 x 6 in. (50 x 152 mm) stud. The dryer vent box was fastened to the 2 x 4 in. (50 x 100 mm) and 2 x 6 in. (50 x 152 mm) studs through three holes on each side of the box using #8 x 1-1/2 in. (38 mm) wood screws. The galvanized steel dryer vent is inserted through the top of the box then caulked at the vent/box interface. The opening cut into the gypsum board shall be a maximum of 10-1/2 in. (267 mm) wide by 17-1/2 in. (445 mm) high. Only one box is permitted per stud cavity.
5	Vent Pipe	Size:	4 in. (101 mm) Round
		Type:	26 gauge galvanized steel

Visit the QAI Online Listing Directory located at www.qai.org for the most up to date version of this Listing and to validate that this QAI Listing is active.