

**QAI Design B1067-1e – ROXUL, Inc. - COMFORTBATT®/COMFORTBOARD™ IS – CAN/ULC 124
 Classification A & B protective covering for foamed insulation**

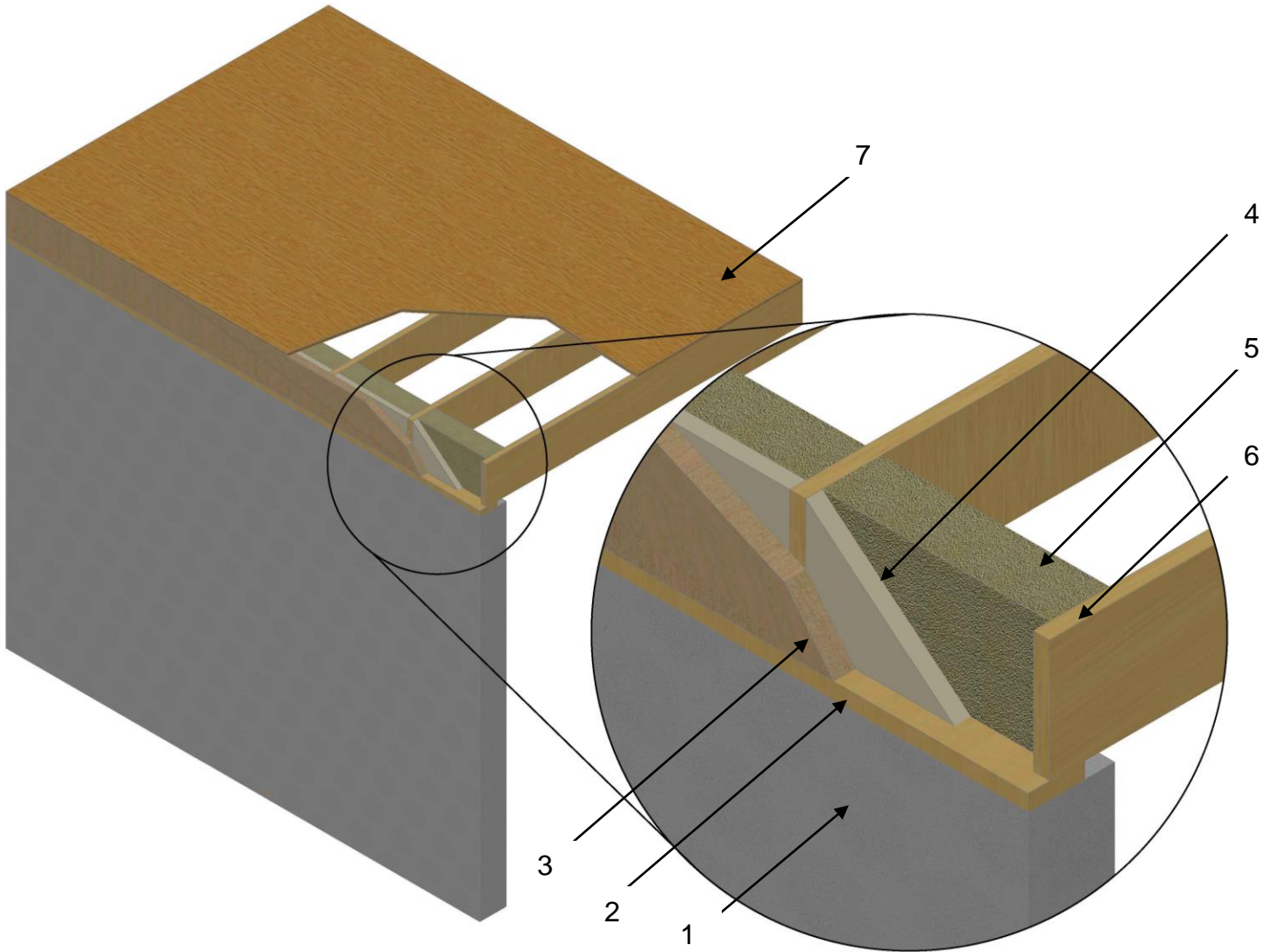

No.	COMPONENT	DESCRIPTION			
1	Concrete Foundation	Concrete foundation wall			
2	Bearing Plate	Standard bearing plate			
3	Rim Joist	Standard rim joist			
4	Foam Insulation	Type:	Foam Plastic		
		Maximum R-Value:	7.5/inch		
5	Protective Covering of Foam Insulation	Certified Manufacturer:	ROXUL Inc.		
		Certified Product Name:	COMFORTBATT®	COMFORTBOARD™ IS	COMFORTBOARD™ IS
		Assembly Class:	Classification B	Classification B	Classification A
		Minimum Thickness:	5-1/2 inch (140 mm)	2 in (50 mm)	3 in (76 mm)
		Minimum Density:	2 lb/ft ³ (32 kg/m ³)	8.0 lb/ft ³ (128 kg/m ³)	8.0 lb/ft ³ (128 kg/m ³)
	Installation:	Friction fit into the joist cavity.			
6	Floor Joists	Standard floor joists system			
7	Sheathing	Standard floor sheathing			